



*Texas
Hill Country*

*Landscape
Option*

*Make yourself
at home in the
Texas Hill Country*

You're moving your family to the beautiful Texas Hill Country, where much of the charm flows from the uniqueness of the rolling hills and beautiful, drought-tolerant plants.

Make your new home as special as its natural surroundings by asking your builder for LCRA's Hill Country Landscape Option.

Look inside and see the many benefits of creating a landscape in harmony with the Texas Hill Country.

You would never skimp on the foundation of your home – good soil is the foundation of a healthy landscape. Six or more inches of soil will help keep your lawn healthy and save water at the same time.

You probably turn off your faucet while you brush your teeth. Don't let a poorly designed irrigation system waste water and money.

Texas summers can be tough. Choose plants that survive and thrive during periods of heat and drought.

Ask your builder for the LCRA Hill Country Landscape Option:

- Quality design to ensure proper placement and spacing of plants
- Appropriate irrigation to match your landscape needs
- Adequate, high-quality soil to provide your landscape with the foundation it needs to grow
- Native and well-adapted plants to thrive in our tough Texas climate
- Information on effective, least-toxic landscaping to keep your landscape safe, healthy and beautiful.

Contact LCRA for more information:
(512) 473-3200, Ext. 2230, or 1-800-776-5272, Ext. 2230

Hill Country Landscape Option Front Yard Sample Design

Landscape Specifications

- 70' wide x 50' deep front yard
- Front yard comprised mainly of shrubs, perennials and ground covers watered every 14 days and turf watered once a week
- 810 gallons per month

Landscape Installation Cost

- Installing a landscape consisting of 6 inches of soil, 80 shrubs and perennials, 2 water-wise trees, 2 palettes of Bermuda "419" grass (800 sq. ft.)
- Total \$3,293
Initial cost (more than standard option) \$853

Water Costs¹

- \$36 per year \$108 savings
 - \$180 for five years \$540 savings
 - \$360 for 10 years \$1,080 savings
- \$3 per month based on a \$3 per 1,000 gallons rate*

Mowing and Landscaping Time

- Mow - ½ hour per week for 37 weeks 18.5 hours
 - Prune and weed - 4 hours, 6 times per year . . . 24 hours
- Total hours per year 42.5 hours
Time saved per year 19 hours

Fertilizers and Chemical Cost

- Landscape chemicals \$0²
- 800 sq. ft. fertilizer \$5 per year⁴

Considerations for Children and Pets

- Nature buffers the impact of life's stresses on children and helps them deal with adversity. The greater the amount of nature exposure, the greater the benefits.
- Children who play regularly in natural environments show more advanced motor fitness, including coordination, balance and agility, and they are sick less often.

¹ Water cost estimates only include front yard landscape watering. These costs are conservative, and plant choice will affect water requirements. Larger lots also will have increased water requirements. Lot sizes are seldom uniform or square, and will ultimately factor into the landscape design and water needs.

² Native and well-adapted plants are disease and pest-resistant and require few if any chemicals.

The Texas Hill Country Landscape Option maintains the beautiful feel of the Texas Hill Country while protecting the environment and saving you time and money.

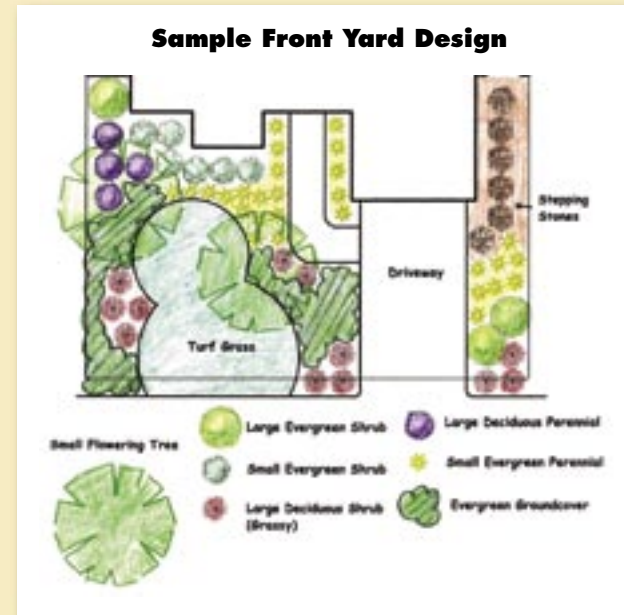

Sample Costs Over 10 Years (Actual Costs Will Vary)

	Hill Country Landscape	Conventional Landscape
Installation Cost	\$3,293	\$2,440
Yard Care Time	425 hours	615 hours
Water Cost	\$360	\$1,440
Treatment Cost	\$50	\$500
Total Time and Cost Over 10 Years	\$3,703 425 hours	\$4,380 615 hours
Difference	\$677 less 190 hours less	\$677 more 190 hours more

Conventional Landscape Option Front Yard Sample Design

Landscape Specifications

- 70' wide x 50' deep front yard
 - Front yard comprised mainly of turf and a few shrubs watered three times a week
 - 3,080 gallons per month
- Uses 3 times more water per month.

Landscape Installation Cost

- Installing a landscape consisting of 3 inches soil, 20 shrubs, 2 trees, 7 palettes of Bermuda "419" grass (2,800 sq. ft.)
- Total \$2,440

Water Costs¹

- \$144 per year
 - \$720 for five years
 - \$1,440 for 10 years
- (\$12 a month based on a \$3 per 1,000 gallons rate)*

Mowing and Landscaping Time

- Mow - 1.5 hours per week for 37 weeks 55.5 hours
 - Prune and weed - 1 hour, 6 times per year 6 hours
- Total hours per year 61.5 hours
Time lost per year 19 hours

Fertilizers and Chemical Cost

- Landscape chemicals \$25³
 - 2800 sq. ft. fertilizer \$15 per year⁴
- Costs \$35 more per year than the LCRA Hill Country Landscape Option.

Considerations for Children and Pets

- Studies show that children and pets can have an increased potential exposure to pesticides and landscape chemicals because they spend more time in contact with the ground than adults.
- Exposure to landscape chemicals increases the risk of disease in children and pets.

³ Estimated cost of one fungicide and one pesticide

⁴ Estimate based on 2004 fertilizer costs
All costs are estimates only. Actual costs may vary.



ABOUT LCRA

LCRA is a conservation and reclamation district created by the Texas Legislature in 1934. LCRA provides energy, water and community services to the people of Texas. It cannot levy taxes, but funds its operations with income from the sale of electricity, water and other services.

LCRA generates electricity and sells it wholesale to 42 customers, including city-owned utilities and cooperatives that serve more than 1.1 million people in Texas. LCRA also builds and operates transmission projects through a nonprofit corporation it created, manages and protects the lower Colorado River, provides water and wastewater utilities, owns and operates parks, and offers economic and community development assistance to communities.



LOWER COLORADO RIVER AUTHORITY

P.O. Box 220

Austin, Texas 78767-0220

1-800-776-5272

(512) 473-3200

Ext. 2230

www.lcra.org



JANUARY 2005